

FLOOR PLANS OF THE A-16 EFP ADVANTAGE

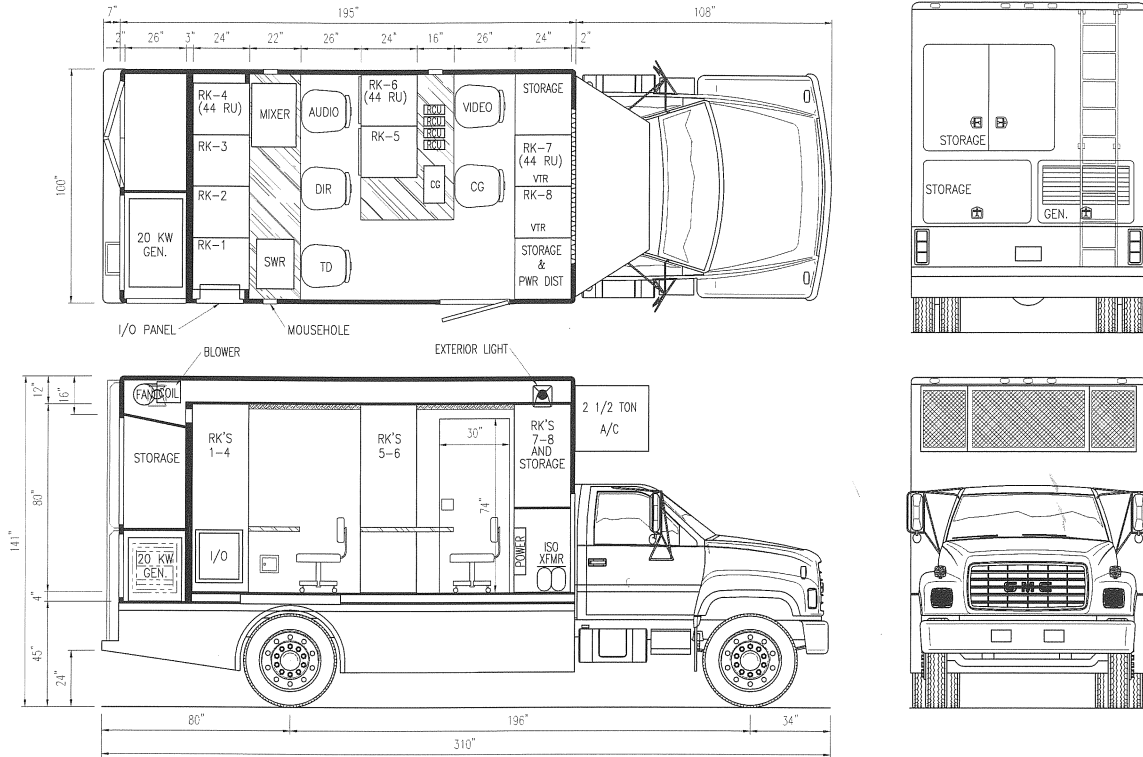

SPECIFICATIONS

THE CHASSIS

GMC C-series 25,900 lb. [11,748 kg] GVWR (Isuzu, Mitsubishi, and Nissan Chassis are available as an option)
 GMC 6.0 liter/366 CI 225 hp V-8 cylinder EFI gasoline engine
 5 Speed Manual Transmission
 Heavy duty cooling system including engine oil cooler
 Electronically operated fold out steps and step well are on Curb Side
 1 - 35 Gallon (132 Liter) Fuel Tank
 Power Assisted Steering
 Power Assisted Brakes
 Heavy Duty Shock Absorbers
 Dual Maintenance Free Batteries
 Comprehensive Gauge Package with Voltmeter, Oil Pressure, Temperature and Fuel Indicators
 100 Amp 12 Volt Alternator
 Front Cab Air Conditioning
 AM/FM Stereo Radio with Clock
 Underbody Undercoating (Petroleum Based)
 Tinted glass
 Floor carpet
 2 side view stainless steel mirrors

AVAILABLE OPTIONS

DC Operated Stabilizing Jacks
 DC Operated Cable Reels
 30 - 42 - 52 - 58 Foot Pneumatic Telescoping Mast
 Logo from Customer Supplied Art work, Custom Exterior Colors
 Telephone system, Fire extinguishers, Awning, Burglar alarm pager,
 Two frame mounted front tow hooks, Compass, Additional deep discharge 220 Amp-hour battery with case, 2000 watt inverter,
 Replace storage cabinet with additional equipment rack for editing

THE HOUSING

Reinforced Interior Walls, Floor and Ceiling, Sound Reducing Ceiling Treatment, Industrial Grade Tight Looped Anti-Static Carpet, Nonflammable, Hard Packed Insulation
 Custom Built Equipment Racks with Operator Console, Heavy Duty .125 Aluminum Tread Plate Roof Platform with Rear Access Ladder, Exterior Paint is GMC Multi-Coat OEM paint (White)
 30,000 BTU Air Conditioner with Shook Hot Gas Bypass Valve Modification. Includes 5KW heat strip
 UL' Approved Power Panel with Separate Circuit Breakers and Individual Power Strips in each rack, 20 kW, 60Hz Generator with Remote Start/Stop
 13.2 KVA Isolation Transformer for Shore Power with Taps for 195/208/220/230 VAC, Digital Voltage/Amp Metering,
 (1) AC Duplex Maintenance Outlet located on the Curb Side
 25 Feet (7.6m) #6-3 with Ground Type "SO" Cable with Inlet Connector, 30 Amp DC Converter with 40 Amp Battery Charger,
 Custom Engraved External I/O Video/Audio Panel with Light
 Interior 12 V DC Ceiling Lights, (1) DC Ceiling Light in Rear Storage Compartment, Removable Swivel Chair(s) with Tie Down (See plan for quantity and location)

SAFETY STANDARDS

(1) Carbon Monoxide Detector (AC Operated)
 First Aid Kit (ICC Approved)
 2.5 lb. Dry Power Fire Extinguisher
 Mast Up - Jacks Down Warning System
 Remote Control Alarm System
 Rear Back Up Alert Signal
 D-TEC or SIGALARM HV Detector (Optional)